



## 3 Lammas Court Moor Lane

Staines-Upon-Thames, TW19 6EA

**Asking price £500,000**



This three bedroom semi-detached house offers scope to extend, subject to planning permission and has a fantastic Southerly aspect garden. Located within walking distance of Staines Moor which is a 510 hectares biological Site of Special Scientific Interest.

The property itself has a through reception room with parquet flooring, working fireplace and bi-folding doors to the garden. The kitchen is at the rear of the property and also accesses the garden. There is a four-piece family bathroom to the first floor, along with the three bedrooms.

There is a private driveway to provide ample off street parking and it leads to the detached garage. As mentioned before the garden is wonderful, with a huge amount of space for all the family it is a great space to enjoy all day and evening. There is a great treehouse and rope swing for the children to enjoy. There is a greenhouse for the green fingered. Beyond the garden there are fields.





## Floor Plan

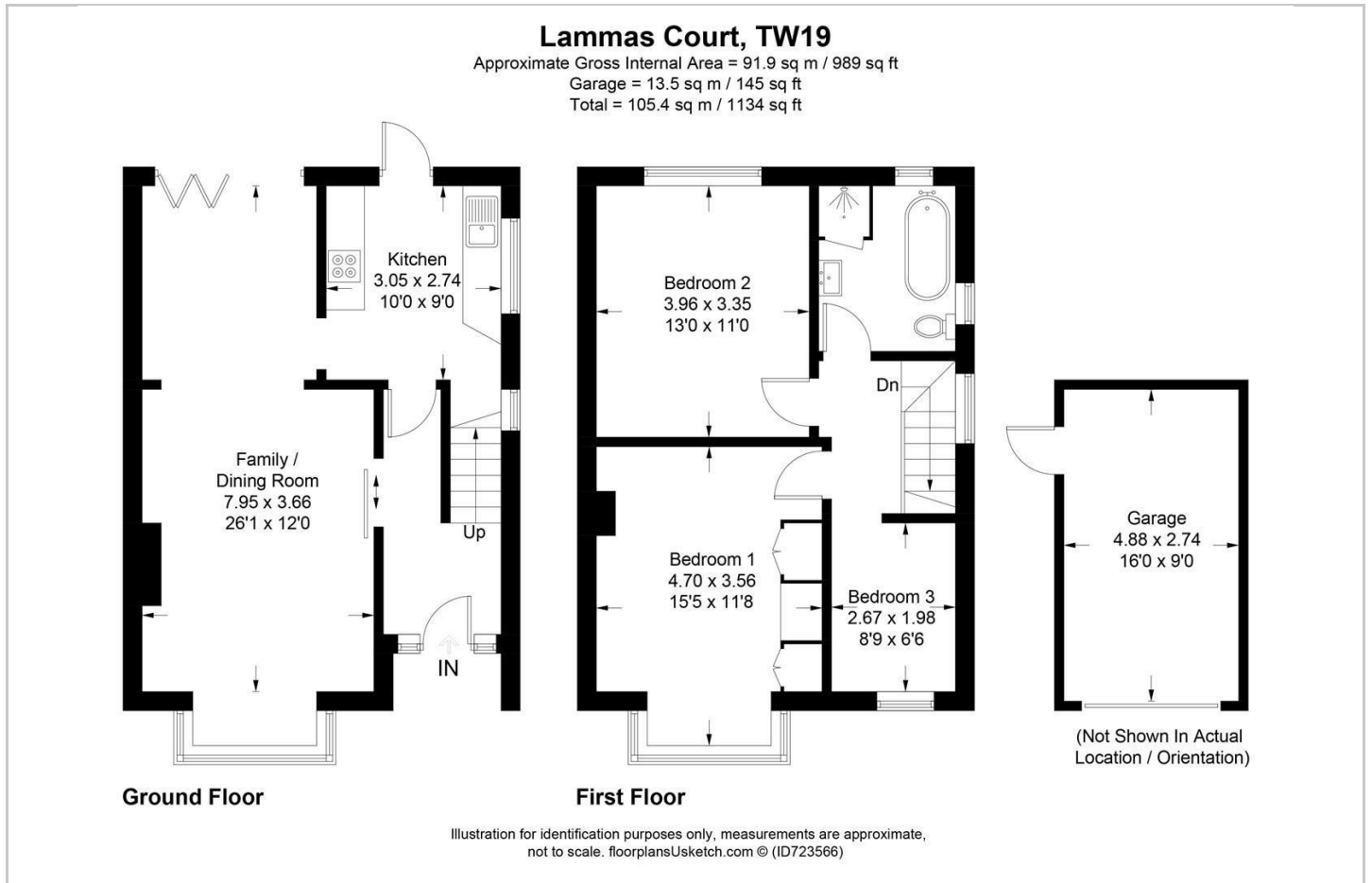

## Area Map

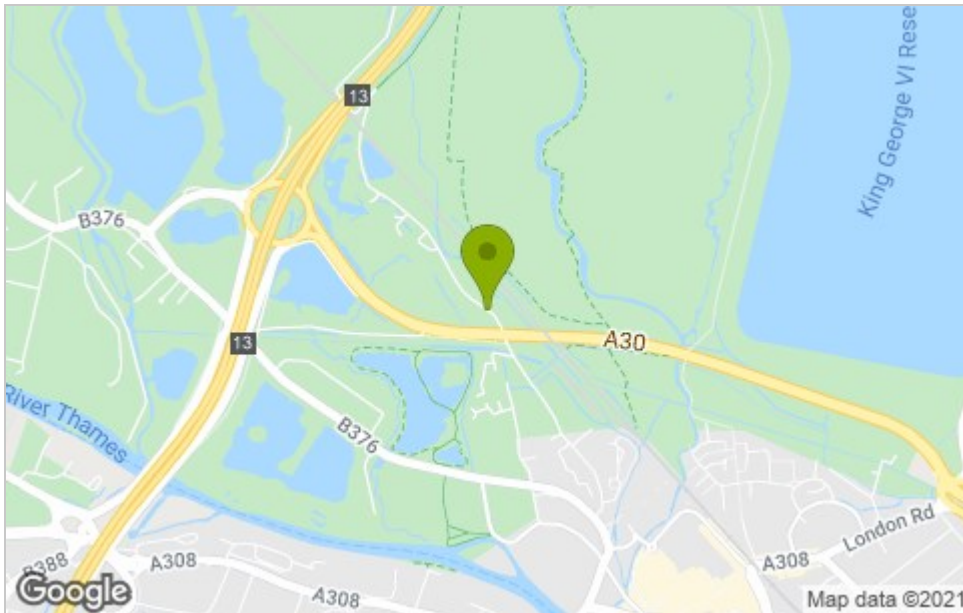

## Viewing

Please contact our Shepperton - Sales Office on 01932232927 if you wish to arrange a viewing appointment for this property or require further information.

These particulars, whilst believed to be accurate are set out as a general outline only for guidance and do not constitute any part of an offer or contract. Intending purchasers should not rely on them as statements of representation of fact, but must satisfy themselves by inspection or otherwise as to their accuracy. No person in this firm's employment has the authority to make or give any representation or warranty in respect of the property.

## Energy Efficiency Graph

